

Drop-in Anchor ED-DW 15

Steel, zinc plated



Description

Drop-in Anchor with DYWIDAG® internal thread¹⁾ DW 15 for post installed threadbar (DYWIDAG®) connections. Suitable for concrete C12/15-C50/60 or hard natural stone. Safe installation if debris makes the thread impassible. The Drop-in Anchor does not protrude out of the concrete after removing the threadbar.

Applications

Multi-functional Anchor for concrete formwork. Cost efficient, quick fixing into existing concrete. Ideal for fixing one-sided formwork or temporary guardrails.

Base Material: concrete C12/15–C 50/60 or hard natural stone

Drop-in Anchor ED-DW 15



- Steel, zinc plated
- For fixing threadbars in formwork

Description	Ref. No.	Drill hole Ø x depth mm	Thread Ø x length mm	Package content pcs.	Weight per package kg
ED-DW 15 x 80	05950101	22 x 80	DW 15 x 35	25	3,76



Standard Setting Tool for Drop-in Anchor ED-DW 15



Description	Ref. No.
E-SW 16 x 80 / DW-15 x 80	9505150

Recommended loads for ED-DW 15

Recommended loads for single anchor without influence of spacing and edge distance. The total safety factor (γ_M and γ_P) is included.

Loads and performance data	Applied load angle		0°	15°	30°	45°	60°	75°	90°
			uncracked concrete						
Recommended loads	C12/15	rec. F [kN]	17,3	16,9	16,8	17,4	18,7	20,6	22,6
	≥ C20/25	rec. F [kN]	19,3	18,7	18,3	18,6	19,5	21,1	22,6
Spacing and edge distance									
Effective anchorage depth	h_{ef}	[mm]	80						
Minimum spacing	s_{min}	[mm]	600						
Minimum edge distance	c_{min}	[mm]	300						
Minimum thickness of concrete slab	h_{min}	[mm]	160						
Installation parameters									
Drill hole diameter	d_o	[mm]	22						
Depth of drill hole	h_o	[mm]	80						
Length of thread	L_{th}	[mm]	35						
Stab/Screw DW15 minimum installation depth		[mm]	28						

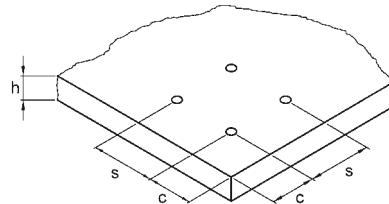
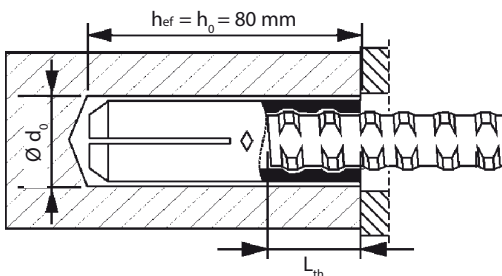
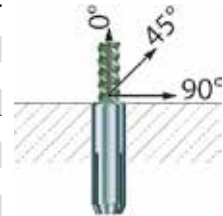

Installation

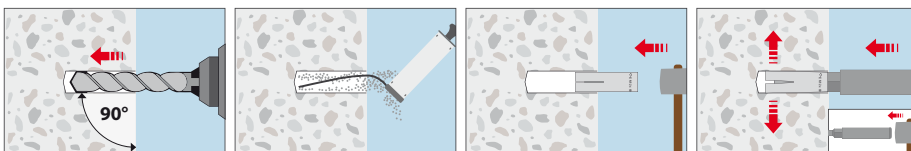

¹⁾ DYWIDAG® internal thread (DYWIDAG® is a registered trademark of Walter Bau AG)